

inserts:

- CXL 2/4 SF .....page 286
- CXL 2/4 SM .....page 286
- CXL SF .....page 286
- CXL SM .....page 286

CJ KF .....page 278

**bulkhead housings**



**cover**



description	part No.	part No.
with lever	<b>CK 03 IN</b> ( black)	
with pegs and gasket		<b>CKG 03 CN</b> ( black)

panel cut-out for enclosures, in mm

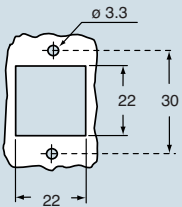

dimensions in mm

**CK IN**

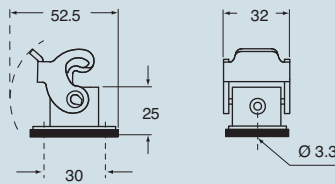

dimensions in mm

**CKG CN**

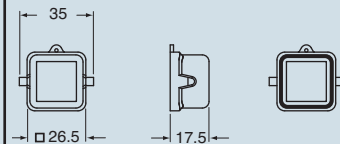

**Note:**  
CXL and CJ K inserts are already supplied with seal and screw, which ensure IP66/IP67 protection rating.

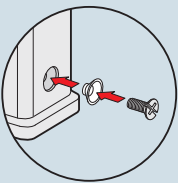

dimensions shown are not binding  
and may be changed without notice

accessories